

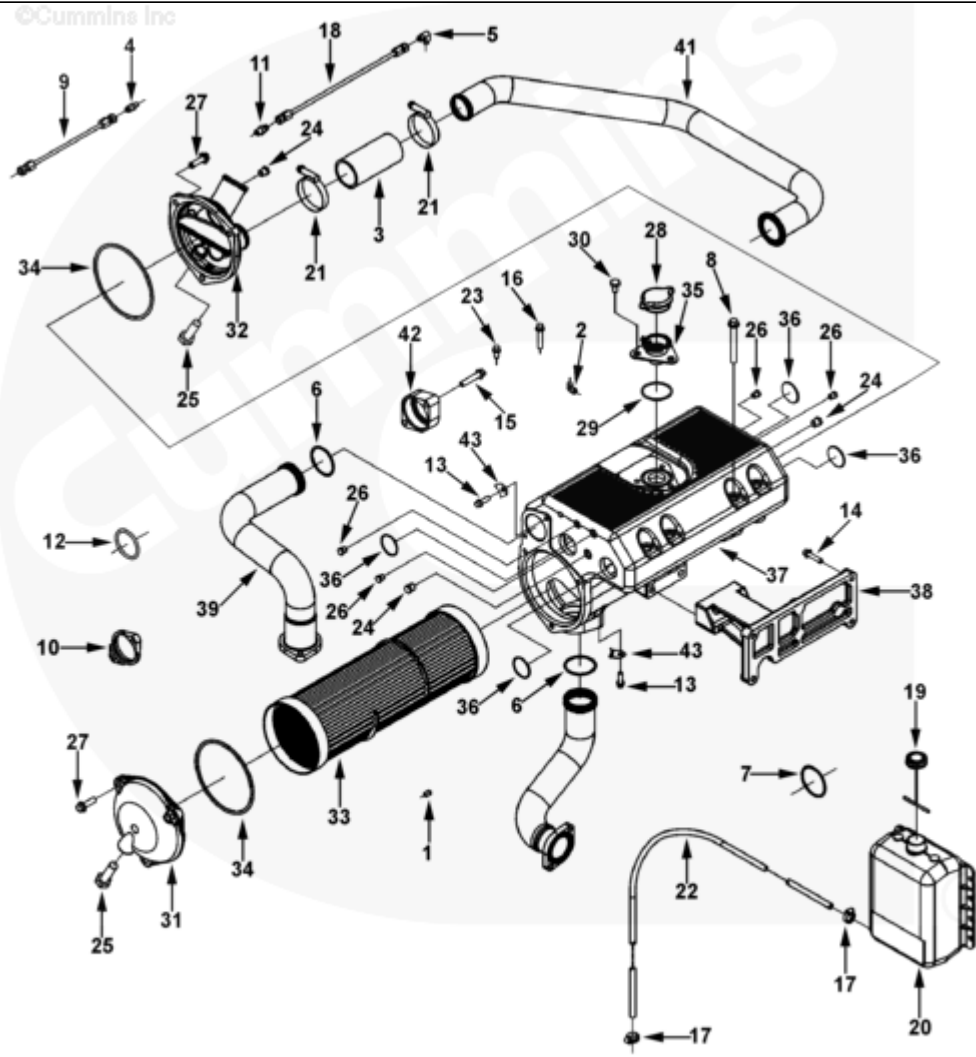

Parts Catalog - Option Detail

Electronic Parts Catalog - Option Detail				
Option	Group	Graphic	Film Card	Date
HX9114-13	08.10	hx954gj	Z	01-MAR-05
Engines	6C8.3, C GAS PLUS CM556, G8.3, G8.3 CM558, GTA8.3 CM558, ISC CM2150, ISC CM554, ISC CM850, ISC8.3 CM2250, ISC8.3 G CM2180 C101, ISL CM2150, ISL CM554, ISL CM850, ISL G CM2180, ISL8.9 CM2150 L110, ISL8.9 CM2880 L112, ISL9 CM2150 SN, ISL9 CM2250, ISL9 CM2350 L101, ISL9 CM2350 L111, ISLE4 CM850, L GAS PLUS CM556, L8.9, L8.9 L121, L8.9G CMOH2.0 L125B, L9 CM2350 L116B, L9 CM2350 L119B, L9 CM2350 L120C, L9 CM2350 L123B, L9.3 L105, L9.5 L117, L9N CM2380 L124B, QSC8.3 CM2250, QSC8.3 CM2880 C102, QSC8.3 CM554, QSC8.3 CM850(CM2850), QSL9 CM2250, QSL9 CM2250 L115, QSL9 CM2350 L102, QSL9 CM2350 L107, QSL9 CM2350 L118, QSL9 CM2350 L122, QSL9 CM554, QSL9 CM850(CM2850), QSL9 G CM558, QSL9 M CM2250 L106, QSL9.3 CM2880 L113			



hx954gj

[SMALL](#) | [MEDIUM](#) | [LARGE](#)

Cart	Ref No	Part Number	Part Description	Required	Remarks
------	--------	-------------	------------------	----------	---------

[View My Cart](#)

		HX9114-13	Heat Exchanger		MR - HEAT EXCHANGER...(More)
					Sea Water Heat Exchanger
					Mounting Location: Exhaust
					Side on Engine
					Expansion Tank Fill Location:
					Right Center
					Engine Aspiration:
					Turbocharged, Sea Water
					Aftercooled
					Exhaust Manifold Type: Wet
					Sea Water Flow: 75 GPM
					Sea Water Outlet (mm): 50.8
					(2.00 in.) Rear Straight Up
<input type="checkbox"/>	1	S 949 B	Pipe Plug	1	1/8 NPT
<input type="checkbox"/>	2	S 1047 A	Male Adapter Elbow	1	1/8 NPTF x 7/16-20 (45)
<input type="checkbox"/>	3	63241 A	Plain Hose	1	
<input type="checkbox"/>	4	68138	Male Connector	3	1/8 NPTF x 7/16-20
<input type="checkbox"/>	5	68139	Male Adapter Elbow	1	1/8 NPTF X 7/16 - 20 (90).
<input type="checkbox"/>	6	145582	O-Ring Seal	2	
<input type="checkbox"/>	7	145583	O-Ring Seal	1	
<input type="checkbox"/>	8	3093936	Hexagon Flange Head Cap Screw	4	M10 X 1.50 X 90
<input type="checkbox"/>	9	3278481	Flexible Hose	1	
	10	3349730	Flange	1	
<input type="checkbox"/>	11	3627856	Male Connector	1	
<input type="checkbox"/>	12	3899728	O-Ring Seal	2	
<input type="checkbox"/>	13	3900631	Hexagon Flange Head Cap Screw	6	M8 X 1.25 X 25.
<input type="checkbox"/>	14	3900632	Hexagon Flange Head Cap Screw	4	M8 X 1.25 X 35.

<input type="checkbox"/>	15	3900634	Hexagon Flange Head Cap Screw	2	M10 X 1.50 X 50.
<input type="checkbox"/>	16	3901445	Hexagon Flange Head Cap Screw	2	M8 x 1.25 x 45
<input type="checkbox"/>	17	3910509	Hose Clamp	2	1/4 - 7/8 in.
<input type="checkbox"/>	18	3916050	Flexible Hose	2	
<input type="checkbox"/>		3922500	Coolant Recovery Reservoir	1	
<input type="checkbox"/>	19	3921339	Expansion Tank Cap	1	
	20	3921480	Coolant Recovery Reservoir	1	
<input type="checkbox"/>	21	3922848	Hose Clamp	4	
<input type="checkbox"/>	22	3924493	Plain Hose	1	
<input type="checkbox"/>	23	3924962	Hexagon Flange Head Cap Screw	2	M8 x 1.25 x 16
<input type="checkbox"/>		3999728	Heat Exchanger	1	
<input type="checkbox"/>	24	3278093	Pipe Plug	3	1/4 NPT
<input type="checkbox"/>	25	68241	Zinc Electrode Plug	2	1/2 NPTF x 2 in.
<input type="checkbox"/>	26	3064947	Pipe Plug	4	1/8 NPT
<input type="checkbox"/>	27	3393717	Hexagon Flange Head Cap Screw	6	M10 x 1.50 x 30
<input type="checkbox"/>	28	3393978	Filler Cap	1	
<input type="checkbox"/>	29	3606661	O-Ring Seal	1	
<input type="checkbox"/>	30	3909582	Hexagon Head Cap Screw	3	M10 x 1.50 x 16
<input type="checkbox"/>	31	3966253	Water Transfer Connection	1	
<input type="checkbox"/>	32	3966254	Water Transfer Connection	1	
<input type="checkbox"/>	33	3999730	Heat Exchanger Core	1	
<input type="checkbox"/>	34	3968022	O-Ring Seal	2	
<input type="checkbox"/>	35	3968822	Fill Connection	1	
<input type="checkbox"/>		3999732	Heat Exchanger Housing	1	
<input type="checkbox"/>	36	3895479	Expansion Plug	4	
<input type="checkbox"/>	37	3999731	Heat Exchanger Housing	1	
<input type="checkbox"/>	38	3966257	Heat Exchanger Support	1	
<input type="checkbox"/>	39	3966258	Water Inlet Tube	1	
<input type="checkbox"/>	40	3966259	Water Inlet Tube	1	
<input type="checkbox"/>	41	3978103	Sea Water Pump Tube	1	

<input type="checkbox"/>	42	3970717	Water Inlet Connection	1	
<input type="checkbox"/>	43	4003347	Tube Clamp	4	

© 2019 Cummins Inc., Box 3005, Columbus, IN 47202-3005 U.S.A.
Terms of Use and Disclaimers | Recommended System Requirements
Need Assistance? Please click on the Contact Us button in the top right corner of any page.